

370-79 Pet Flap Replacement Instructions

From the inside of the door, remove and set aside all screws that fasten the 4 lock trim pieces to the door (Fig 1). Keep track of the position that each lock trim piece was installed to make re-installation easier. Using a block of wood tap the left lock trim towards the edge of the door (Fig 2). Remove and set aside. Repeat for the right side. Tip the top lock trim toward you to release the interlocking lip (Fig 3). You may use a screwdriver to pry. Remove and set aside.

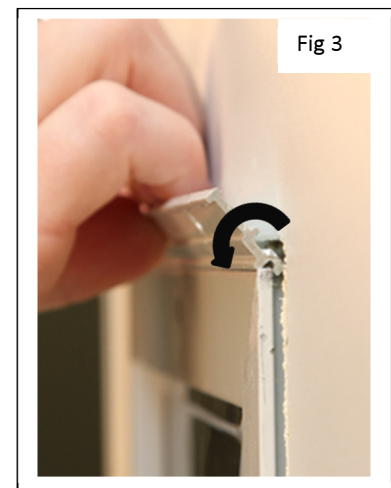

Place a flat screwdriver against the edge of the bottom lock trim (Fig 4). Tap the handle of the screwdriver until it moves the lock trim 1-1 1/2" (Fig 5). Tip the lock trim towards you to release the interlocking lip (Fig 6). You may use a screwdriver to pry. Remove and set aside.

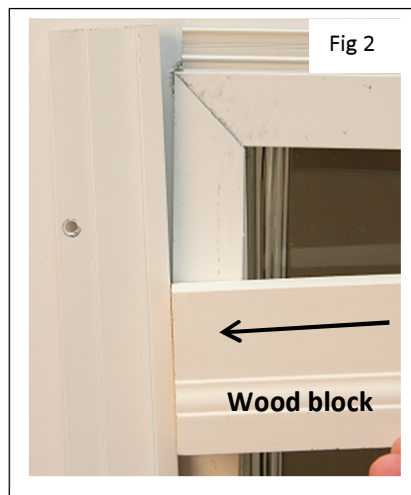
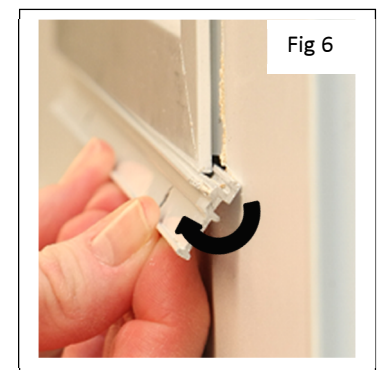
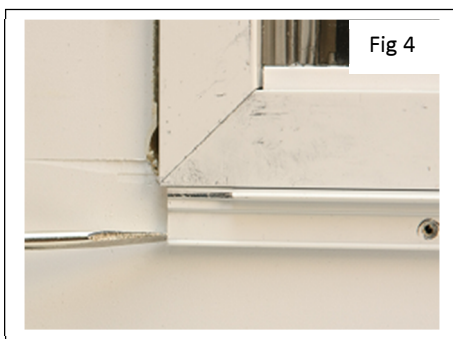

From the outside of the door, remove the pet door frame.

Next, remove the top screw from one side of the frame (Fig 7) and set aside. Lean the side frame slightly away at the top (Fig 8). Slide the flap out of the frame (Fig 9).

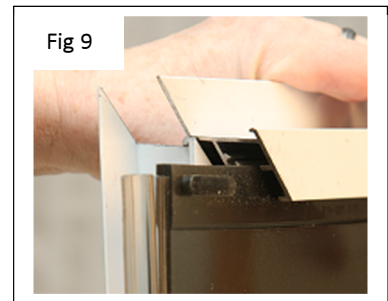
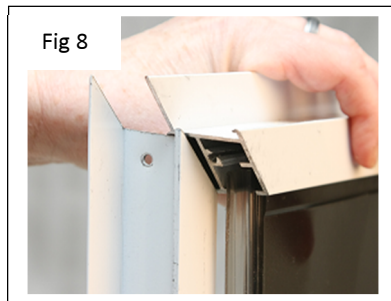
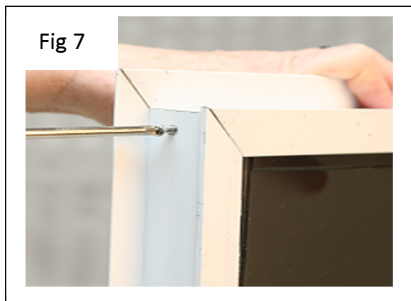

Install the new flap with textured side facing out. Align the side of the frame and attach with the screw that was just removed.

Place pet door frame in the opening. Gently tap on the frame until it fits flush against the storm door. Lift the pet door frame so there is a small space at the bottom. Next, install bottom lock trim so the interlock engages the pet door frame and rotate the bottom away from you (Fig 10). The holes in the lock trim will line up with the holes in the door. Secure with screws you set aside previously. Repeat for the top (Fig 11). Next, rest the right lock trim against the pet door frame. Push it snug against the door and tap it towards the center of the door. The interlock on the lock trim will secure behind the interlock of the pet door frame. The lock trim holes will line up with the holes in the door. Secure with screws (Fig 12). Repeat for the left side. Test flap operation.

